

A Project by



*Designed for an exclusive lifestyle.*

LUXURY 2 BHK APARTMENTS, VEENUS ENCLAVE @ GAJULARAMARAM.

Sai's   
Samhitha  
A life of freshness.







Sai's  
**Samhitha**  
A life of freshness.

Healthy living begins in the lap of nature. We all earn to come back to a home where in the hum of nature, our worries disappear. **Sai's Samhitha** designed with wide open outdoors landscaped with trees, Welcome to an architectural delight that sets new standards in luxury living. A beautiful elevation sets the stage for the finest infrastructure inside, with every modern amenity needed for stress-free living.

*Enjoy the glory of elevated lifestyle*







Enshrined in a nest of lush greenery, **Sai's Samhitha** enriches your lifestyle with unprecedented attention to the environment that not only protects your health but also enhances it. An exclusive residential environment packed with soothing and serene green expanse helps you to enjoy every moment.

AREA STATEMENT

Flat No.	Facing	Salable Area in Sft.
1	West	1275
2	East	1275
3	West	1275
4	East	1300
5	East	1300
6	East	1250
7	East	1250
8	East	1250
9	West	1300



TYPICAL FLOOR PLAN



## AMENITIES & FEATURES

- |                                |                                                                                              |
|--------------------------------|----------------------------------------------------------------------------------------------|
| ■ Municipal water              | ■ Excellent ventilation                                                                      |
| ■ Power backup generator       | ■ GHMC approved Project                                                                      |
| ■ Independent flats            | ■ 15 mins drive from KPHP                                                                    |
| ■ Car parking                  | ■ Near restaurants, educational institutions, malls & shopping complexes and cinema theaters |
| ■ Ideal location               | ■ Rain water harvesting                                                                      |
| ■ Premium quality construction | ■ 24 X 7 security.                                                                           |
| ■ Earthquake-resistant design  |                                                                                              |
| ■ Designed as per Vasthu       |                                                                                              |

## CELLAR FLOOR PLAN

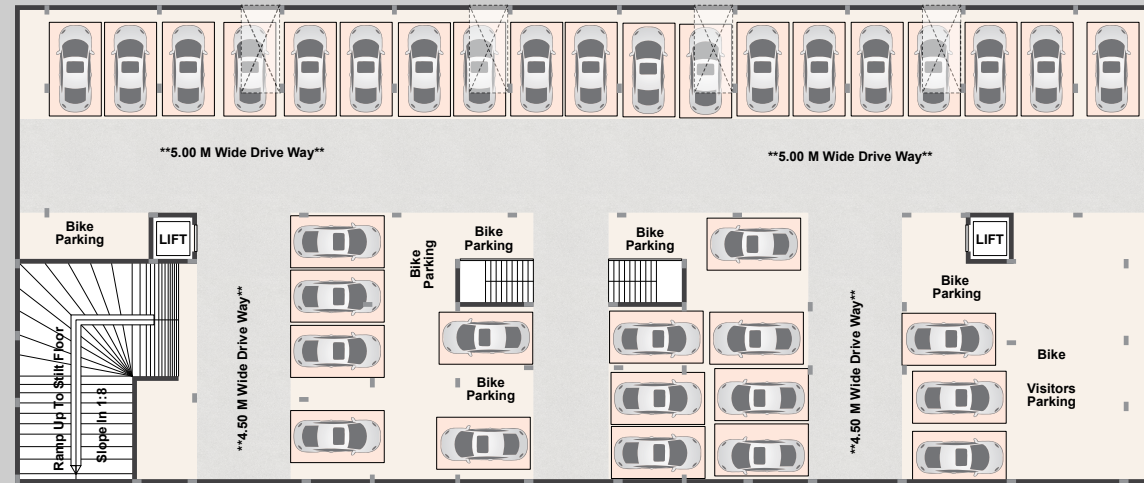

## Sai's Samhitha SPECIFICATIONS

**FOUNDATION & STRUCTURE**  
RCC Framed Structure

**SUPER STRUCTURE**  
Red Clay Brick Work In Cement Mortar.

**PLASTERING**  
Internal: Double Coat Cement Plastering Finished With Luppam  
External: Double Coat Cement Plastering

### JOINERY WORKS

Main Door: Good Quality Teak Wood Frame With Designer Teak Veneer  
Shutter Fixed With Quality Hardware  
Internal Doors: Good Quality Teak Wood Frame With Designer Flush Shutter Fixed With Good Quality Hardware  
Windows: UPVC Single Glazed Glass Sliding Door With Bucks Shutter Standard Hardware



### ELECTRICAL

- Concealed copper wiring of standard make
- Power outlets for A/C in master bedroom & guest bedroom
- Provision for geyser in all bathrooms
- Power plug outlets for cooking range chimney, refrigerator, micro oven, mixer/grinder in kitchen
- 3-phase supply for each unit and individual master boards
- Miniature circuit breakers (MCB) for each distribution boards

## GROUND FLOOR PLAN



### FLOORING

Dining, Living: Vitrified Tiles Of Size 24"x24"  
Bedroom: Vitrified Tiles Of Size 24"x24"  
Kitchen : Ceramic Tiles Of Size 12"x12"  
Toilets : Best Quality Acid Resistant, Anti Skid Designer Tiles  
Kitchen Platform : Granite Platform With Steel Sink, Provision For Bore & Municipal Water Connection, Provision For Cabinets And Exhaust Fan

### TOILETS (All Toilets Consists Of)

- Medium size wash basin Parryware/ Cera or equivalent make
- E.W.C. in master bedroom with flush tank Parryware/Cera or equivalent make
- I.W.C. for other toilet with flush tank Parryware/Cera or equivalent make
- Hot and cold wall mixer with shower
- All fixers are C.P. coated best quality standard branded make

### TILE CLADDING & DADOING :

Toilets: Best Quality And Resistant Body Designer Glazed Ceramic The Dado Upto Door Level  
Kitchen: Glazed Ceramic The Dado Upto 2' Height Above Kitchen Platform  
Utility/Wash: Glazed Ceramic Tiles Dado Up To 3' Height

### PAINTING

Internal: Two Coats Of Emulsion Paint Over A Base Coat Of Primer  
External: Two Coats Of Exterior Paint Over A Wall Care Putty/ Premium Quality Texture Paint  
Common Area: Oil Bound Distemper

### TELEPHONE & CABLE TV

Provision for master bedroom and drawing/living room.

### POWER BACKUP

Power backup generator facility for lifts, common area, limited points in flats

### LIFT

Standard make lifts

### NOTE

- Shelves, chajjas, lofts, arch etc. are optional with extra cost
- GST, registration and service tax applicable as per government norms
- Customers desiring to alter/ modify shall inform the same at the time of booking only.



Builders & Developers



## Avantika Sai Ram Projects

# 8-3-319/10/1, Flat No. 402, Swarnalatha Estates, Sai Saradhi Nagar, Ameerpet, Keerthi Apartments Ln, Yella Reddy Guda, Hyd, Telangana 500073.

Ph : 040-040-6646 7899, Cell: 92461 15223,  
88017 02452, 92461 92678, 88859 17567

web site : [www.rsrprojects.com](http://www.rsrprojects.com)



Scan QR Code



To View Website

### SOME OF OUR PROJECTS



**SAI'S SUVIDHA**  
@ Gajularamaram.



**SAI'S SANNIDHI**  
@ Hafeezpet



**SAI'S SHRAVYA ENCLAVE**  
@ Gajularamaram.



**SPOORTHY AVENUE**  
@ Gajularamaram.



**BALAJI CLASSIC**  
@ Sri Balaji Layout, Gajularamaram

### LOCATION MAP (Not to scale)

Scan QR Code



To get directions to this site via Google Map

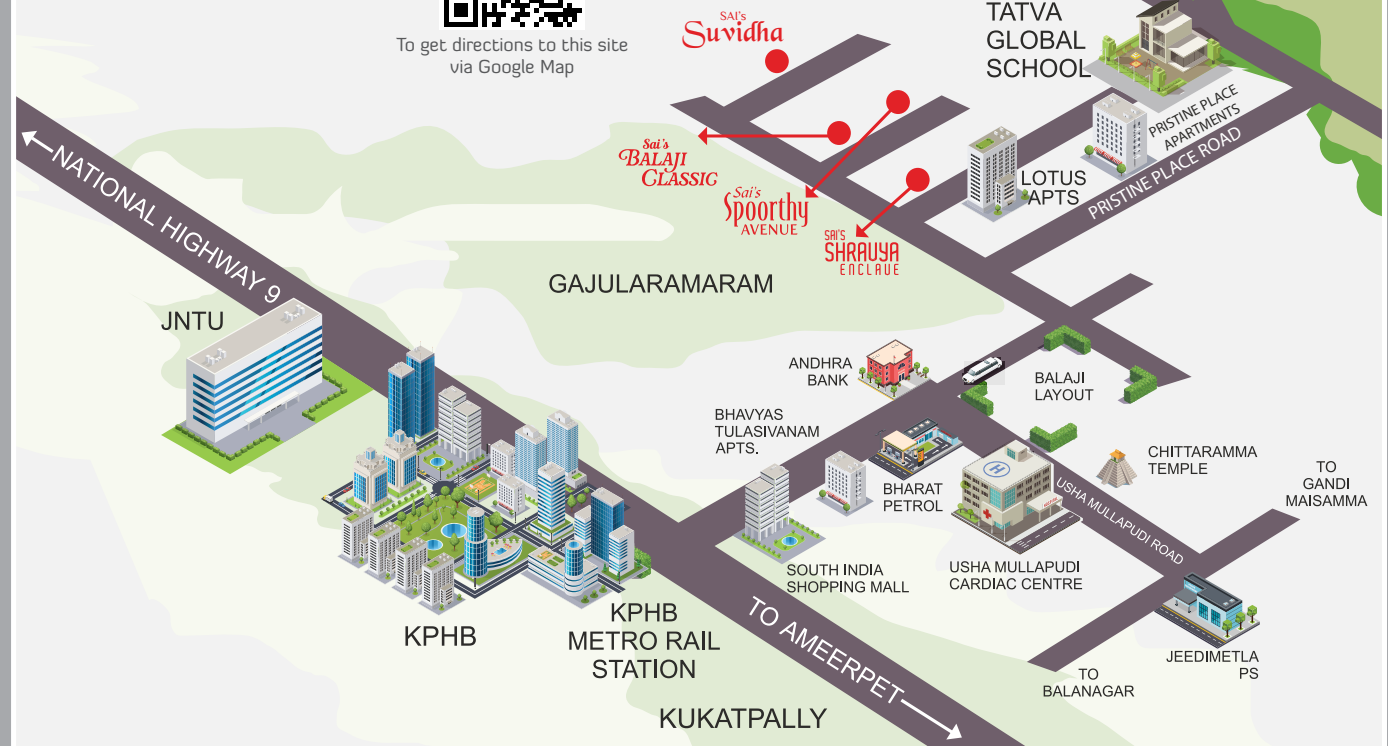

NOTE: This brochure is only a conceptual presentation of the project and not a legal offering. The promoters reserve the right to make changes in plans, specifications and elevation as deemed fit.

DISCLAIMER: Disclaimer: The information provided in the brochure (including any images, brochures, plans etc) is for informational purposes only and you shall not rely or depend on such information for the purpose of making any purchase in any of our projects. The information in the brochure does not constitute an invitation to purchase, advertisement, marketing or offer for sale of any of the units in our projects. We will be taking steps for registration of the project in accordance with the Real Estate Regulation Authority Act, 2016 as soon as the authority is constituted.

The project is approved by

